

Georg Bohle

Other Spaces

Galerie Frank Taal

21.04 - 27.05.2017

Frank
taal



Georg Bohle – Other Spaces – EN

1977, Bochum, Duitsland

Georg Bohle views the built environment and pristine landscapes as cultural metaphors that provide a context for his work. Some of Bohle's drawings show graphic interpretations of textures and compositional structures from man-made agglomerations. Other works display mountain sceneries with anthropomorphic rock formations.

Within the tension between architectural and natural forms, Bohle develops a growing series of Imaginary Landscapes. Amid realistic and imaginative elements grows a repertoire of volumes, textures, objects and emblems which, combined, give his landscapes new meaning. Looking at the the ambiguity of the curious and the familiar in Bohle's drawings one may turn to Michel Foucault's notion of 'heterotopia' that he elaborated in 'Of Other Spaces' (1967). One may borrow this notion to contemplate Bohle's works for they seem to exist in a space of 'otherness': it is neither here nor there.

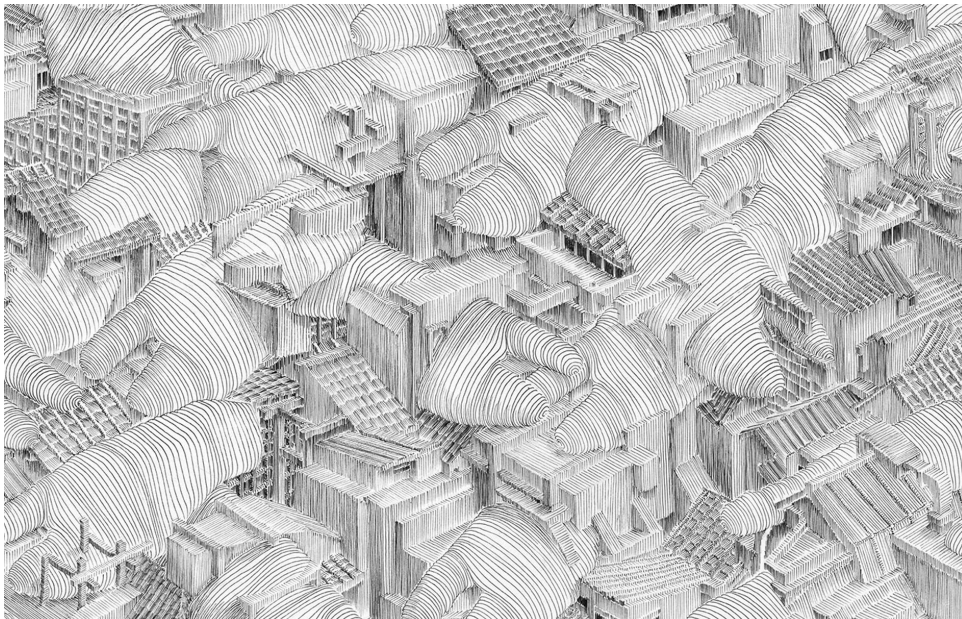

Detail from City 18, Detail uit City 18

Georg Bohle – Other Spaces – NL

1977, Bochum, Duitsland

Georg Bohle ziet de gebouwde omgeving en ongerepte landschappen als culturele metaforen die een context bieden voor zijn werk. Sommige van Bohle's tekeningen tonen grafische interpretaties van texturen en compositorische structuren in door de mens gemaakte agglomeraties. Andere werken tonen berglandschappen met antropomorfe rotsformaties.

Binnen het spanningsveld van architectonische en natuurlijke vormen, tussen werkelijkheid en het buitenwereldse, ontwikkelt Bohle een groeiende reeks van imaginaire landschappen. De dubbelzinnigheid van curiositeit en herkenbaarheid in Bohle's tekeningen doet denken aan het begrip 'heterotopie' dat Michel Foucault uitwerkte in zijn essay 'Of other spaces' (1967). Men kan dit begrip ontleen om Bohle's tekeningen te aanschouwen want ze lijken te bestaan in een ruimte die noch hier is, noch daar.





City 3, 2008, Black fineliner on paper, 80 x 105 cm, € 3500,-

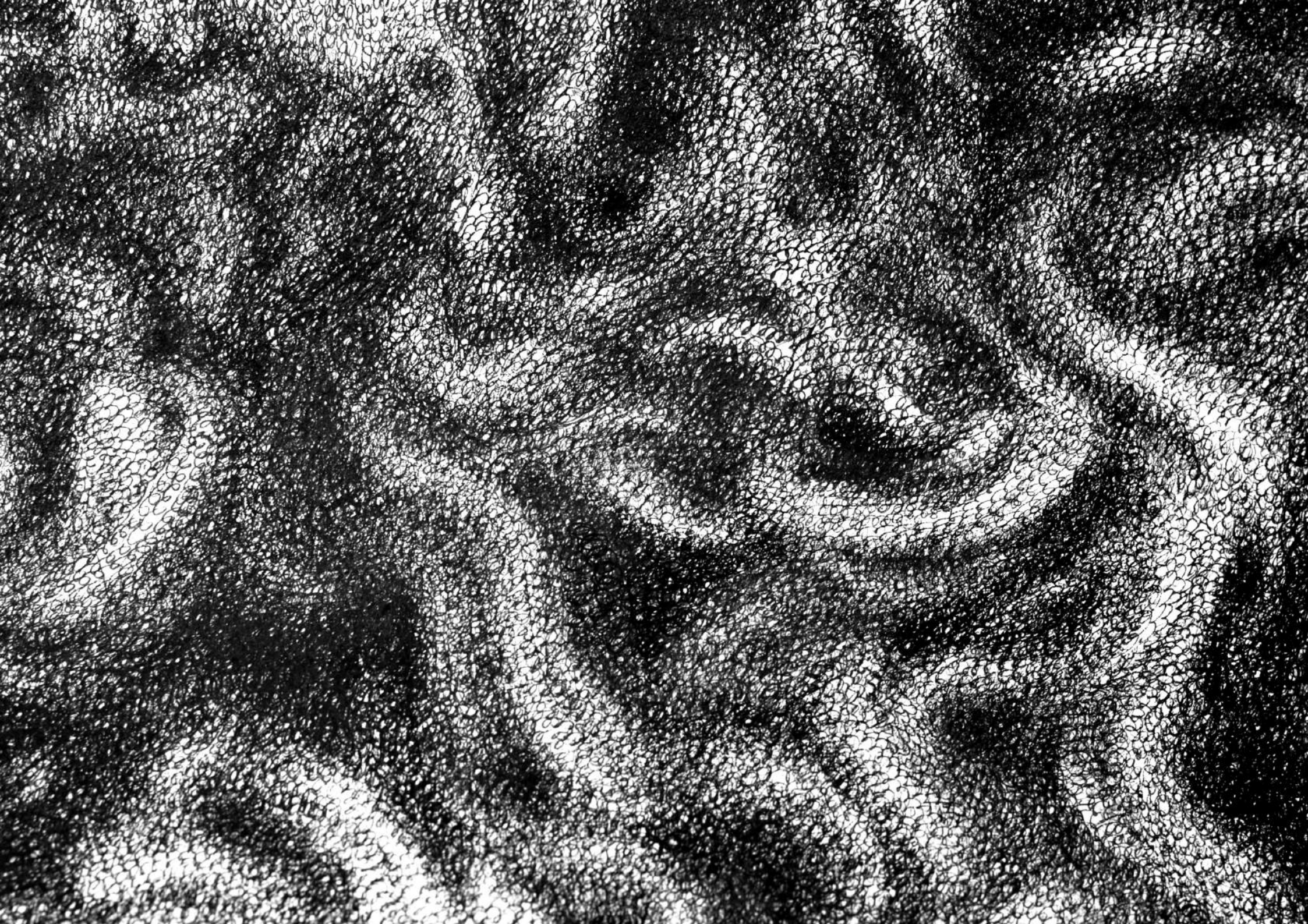

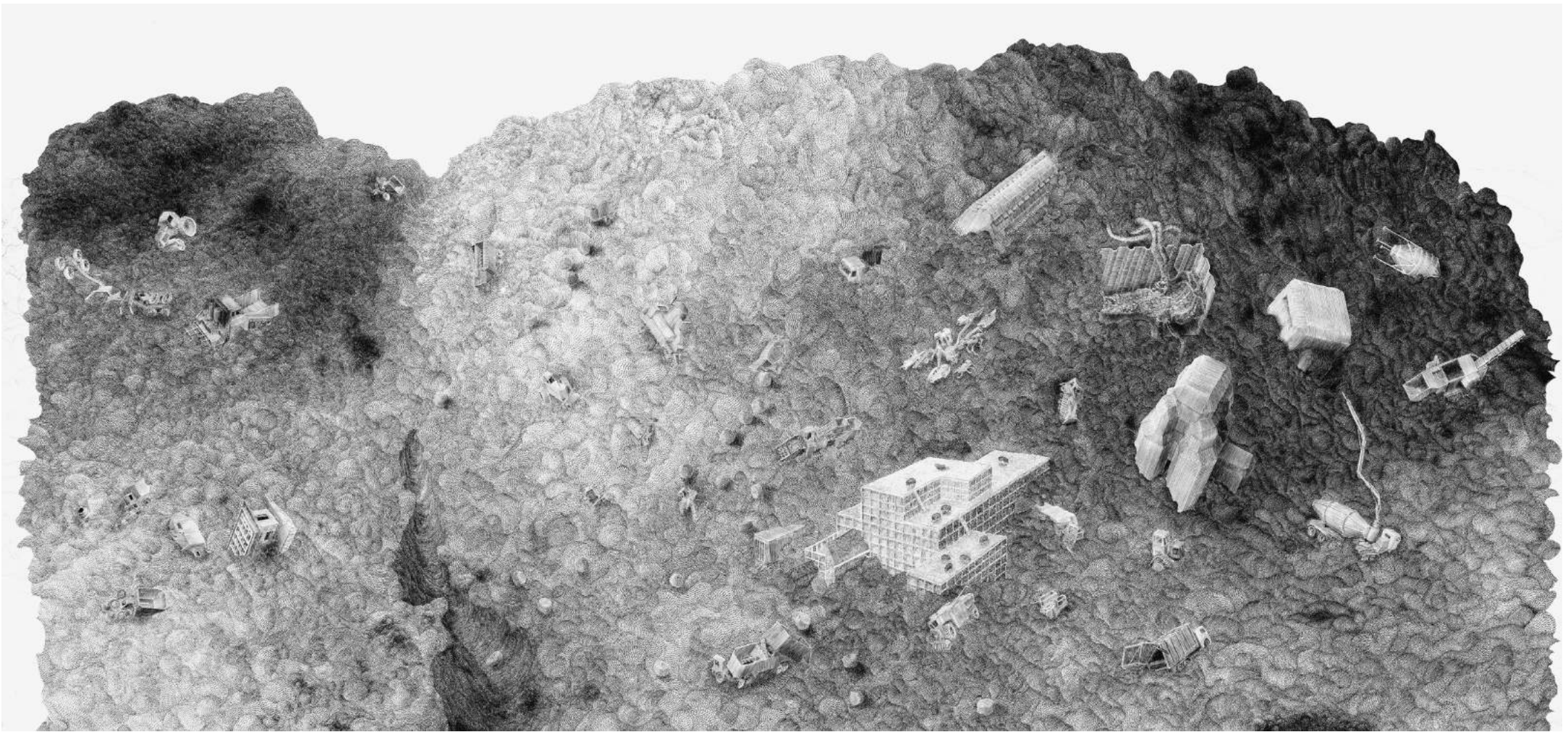

City 6, 2011, Black fineliner on paper, 80 x 105 cm, € 8500,-

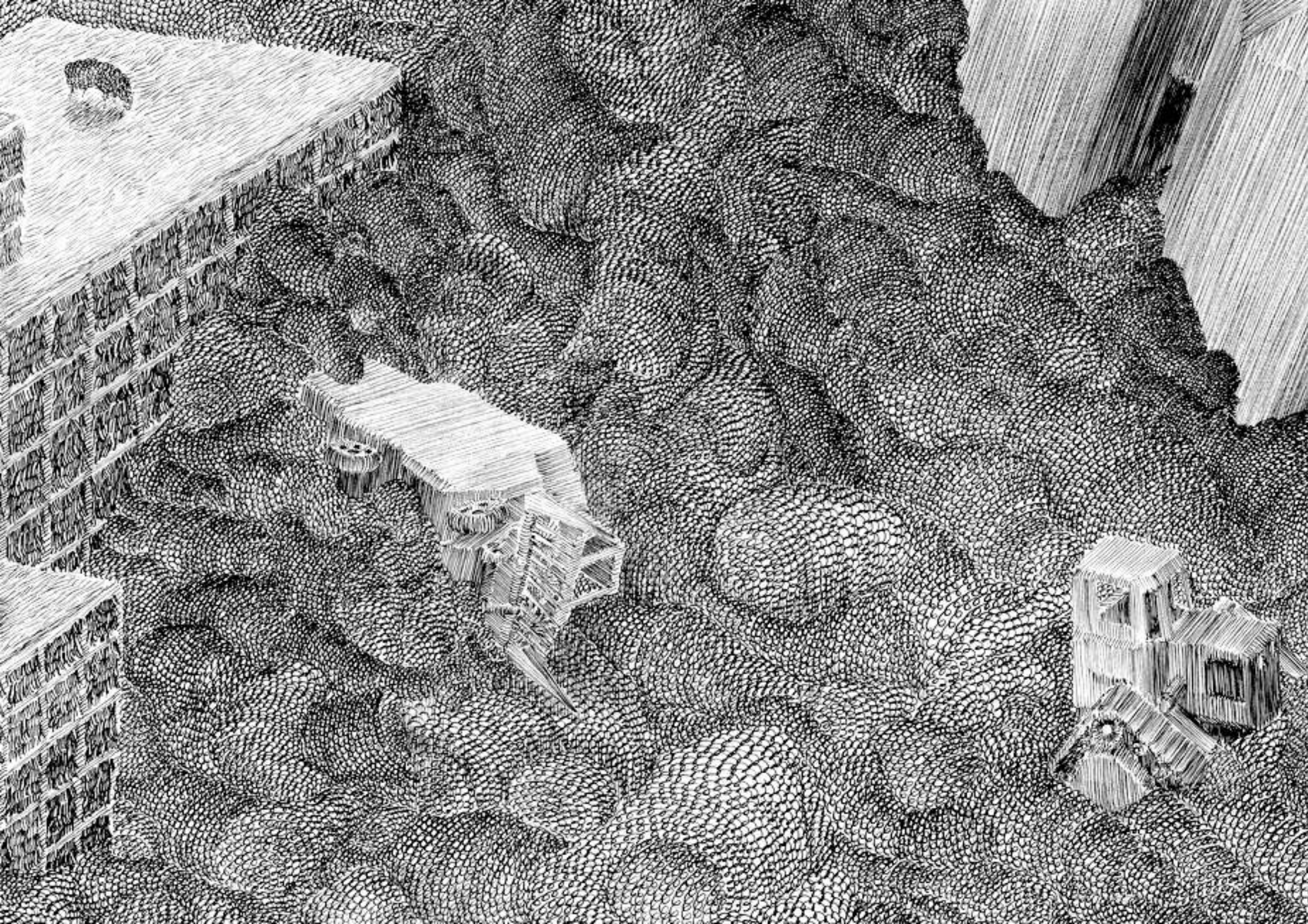

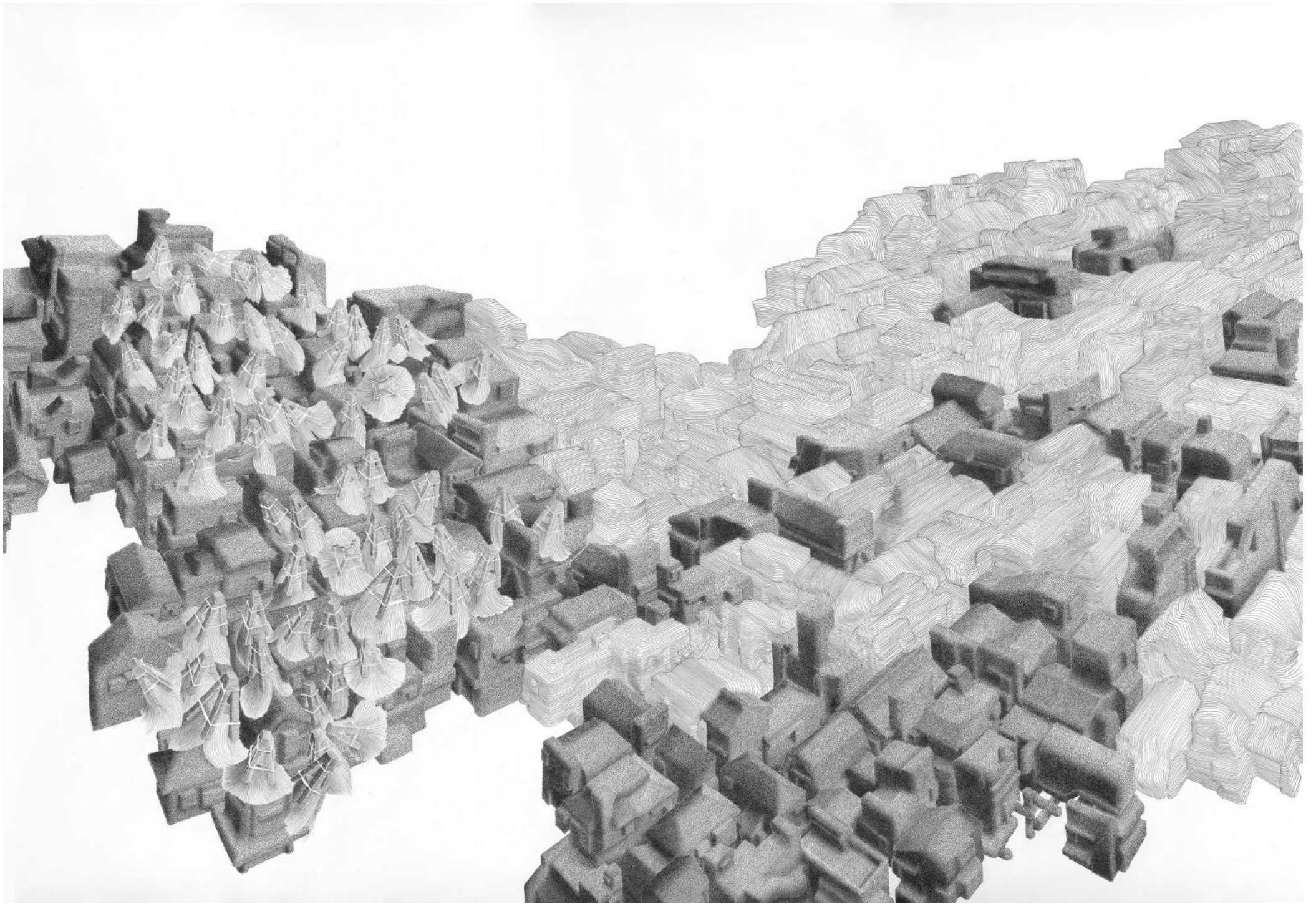

City 11, 2012, Black fineliner on paper, 170 x 115 cm, € 7000,-

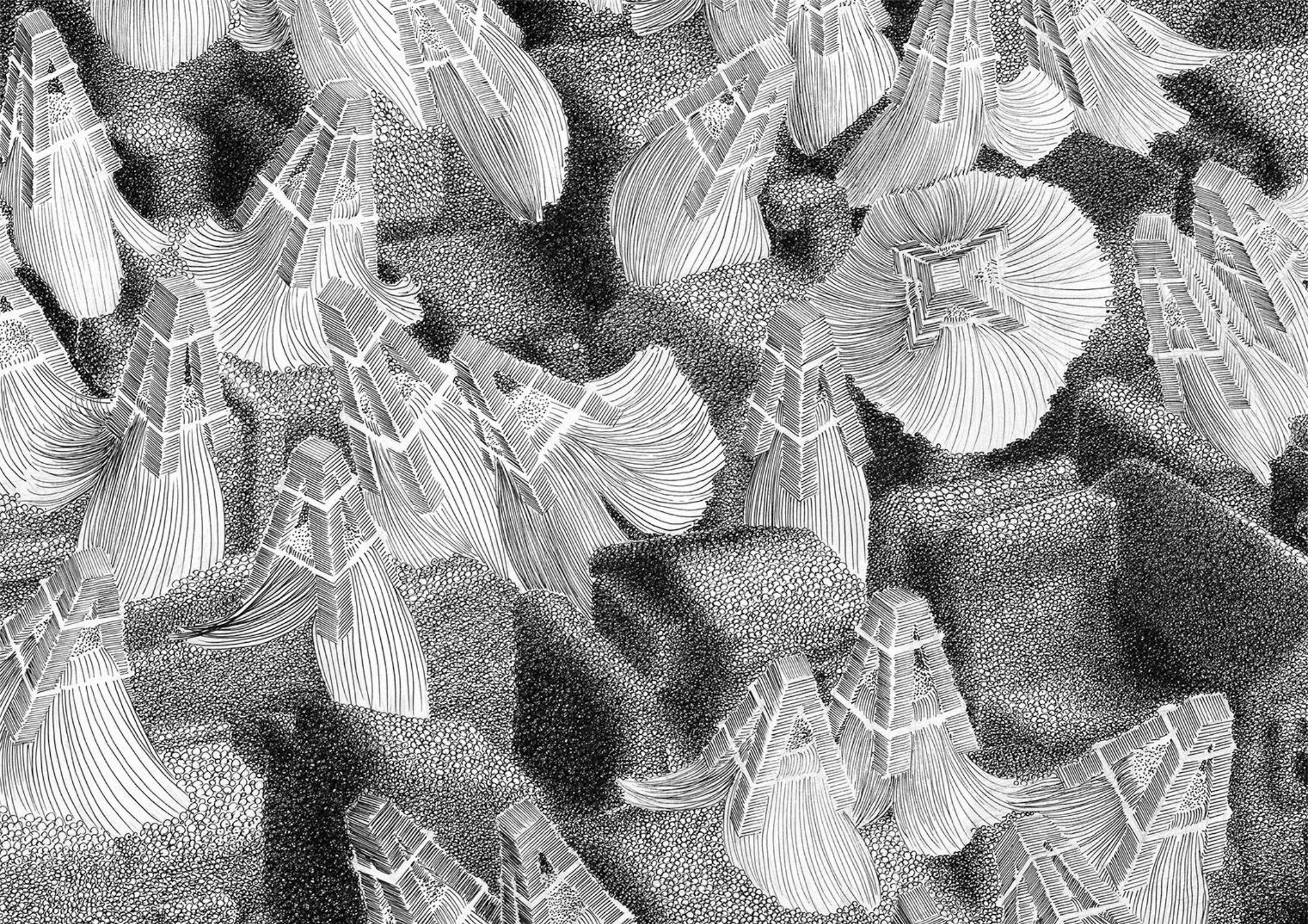

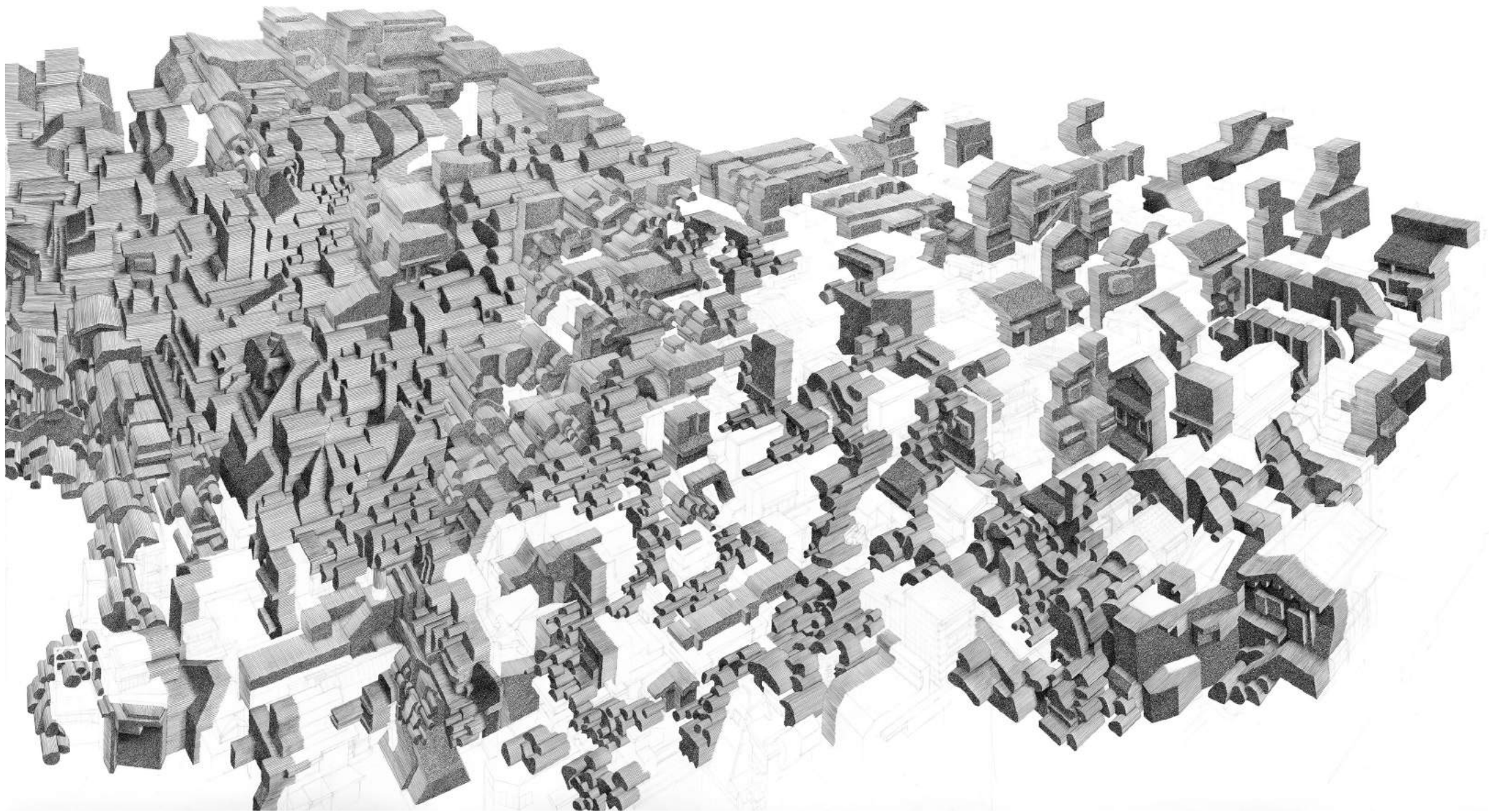

City 12, 2012, Black fineliner on paper, 180 x 108 cm, € 7000,-

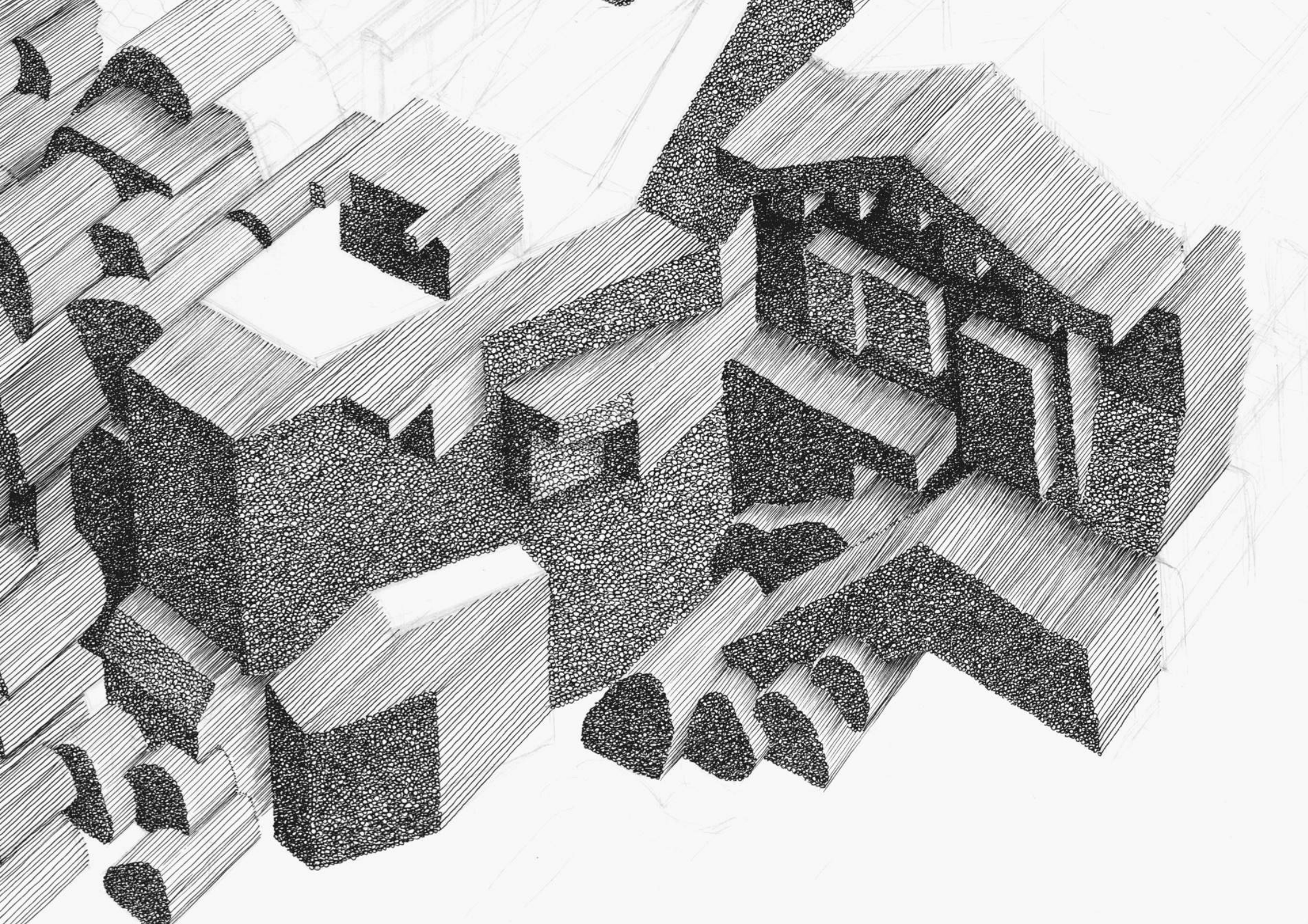

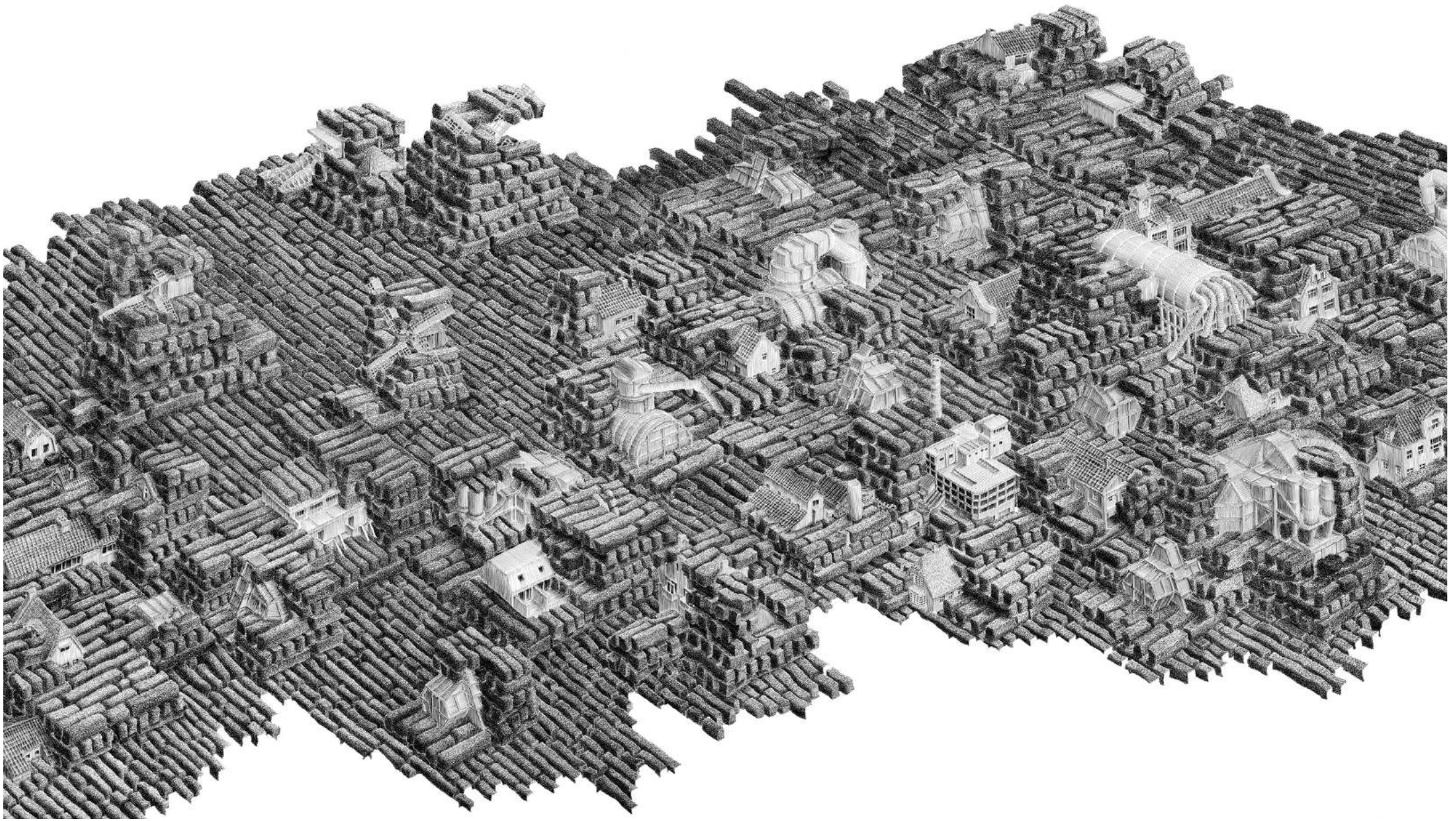

City 15, 2013, Black fineliner on paper, 172 x 110 cm, € 7000,-

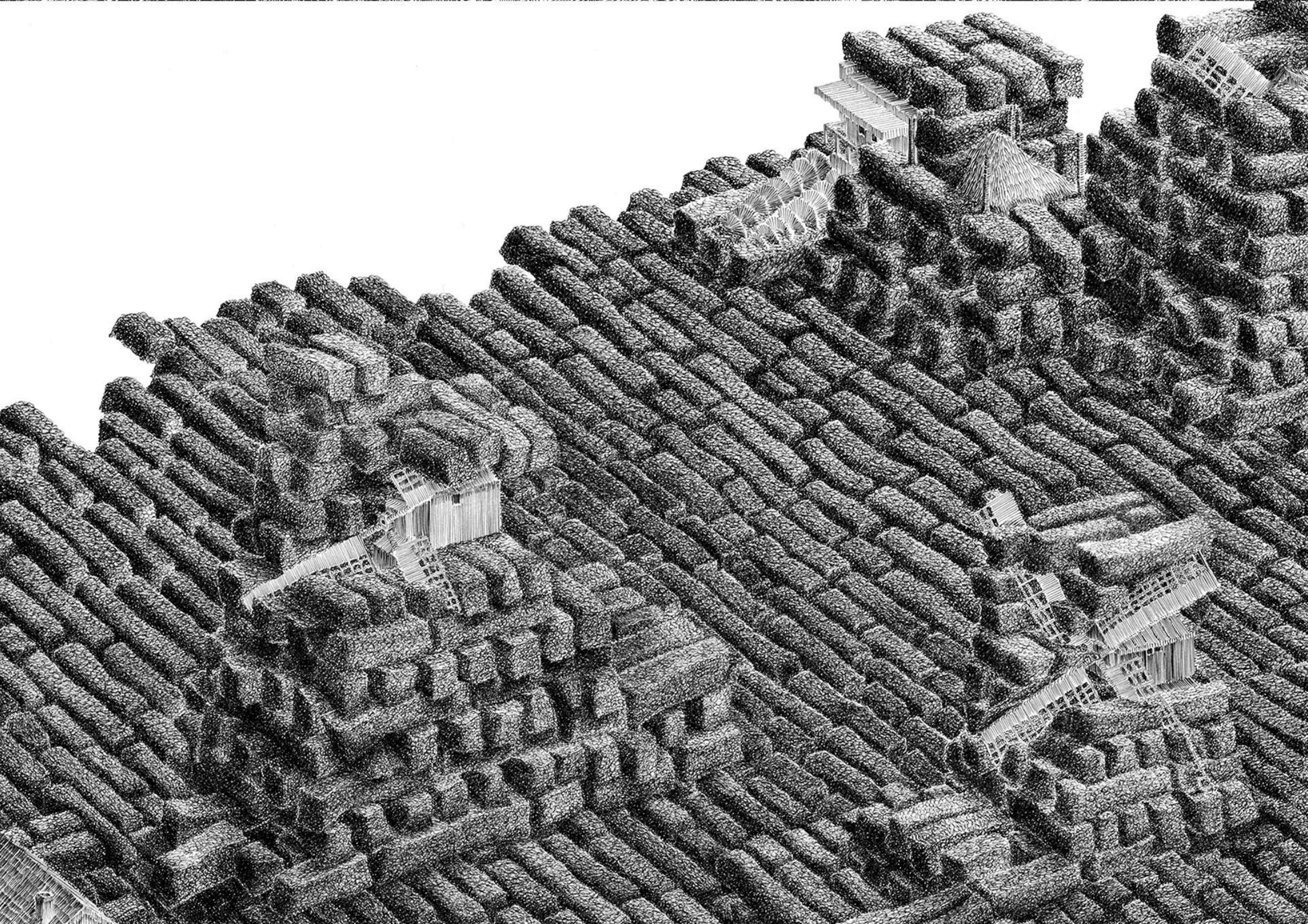



City 17, 2013, Black fineliner on paper, 97 x 210 cm, € 7500,-

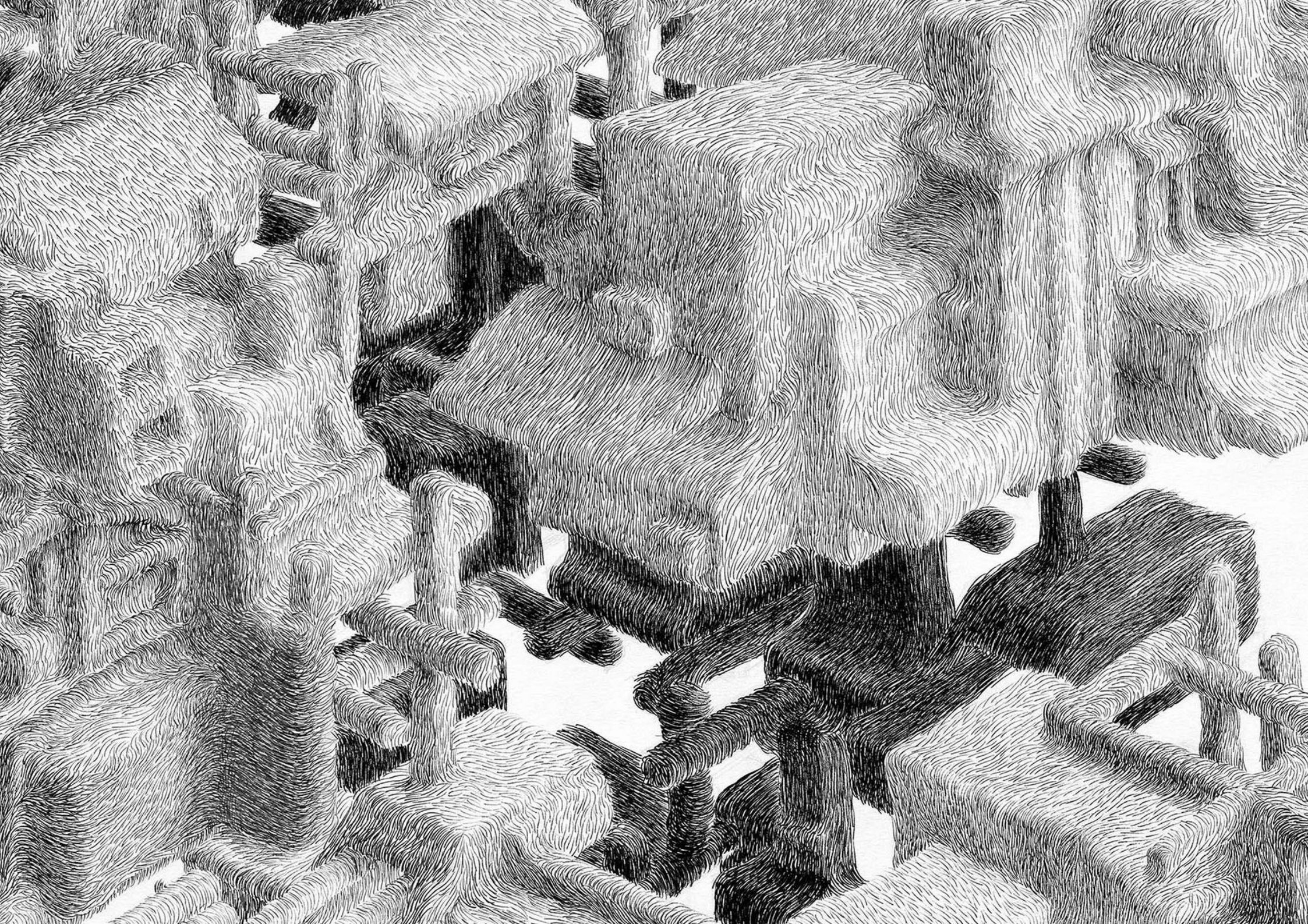

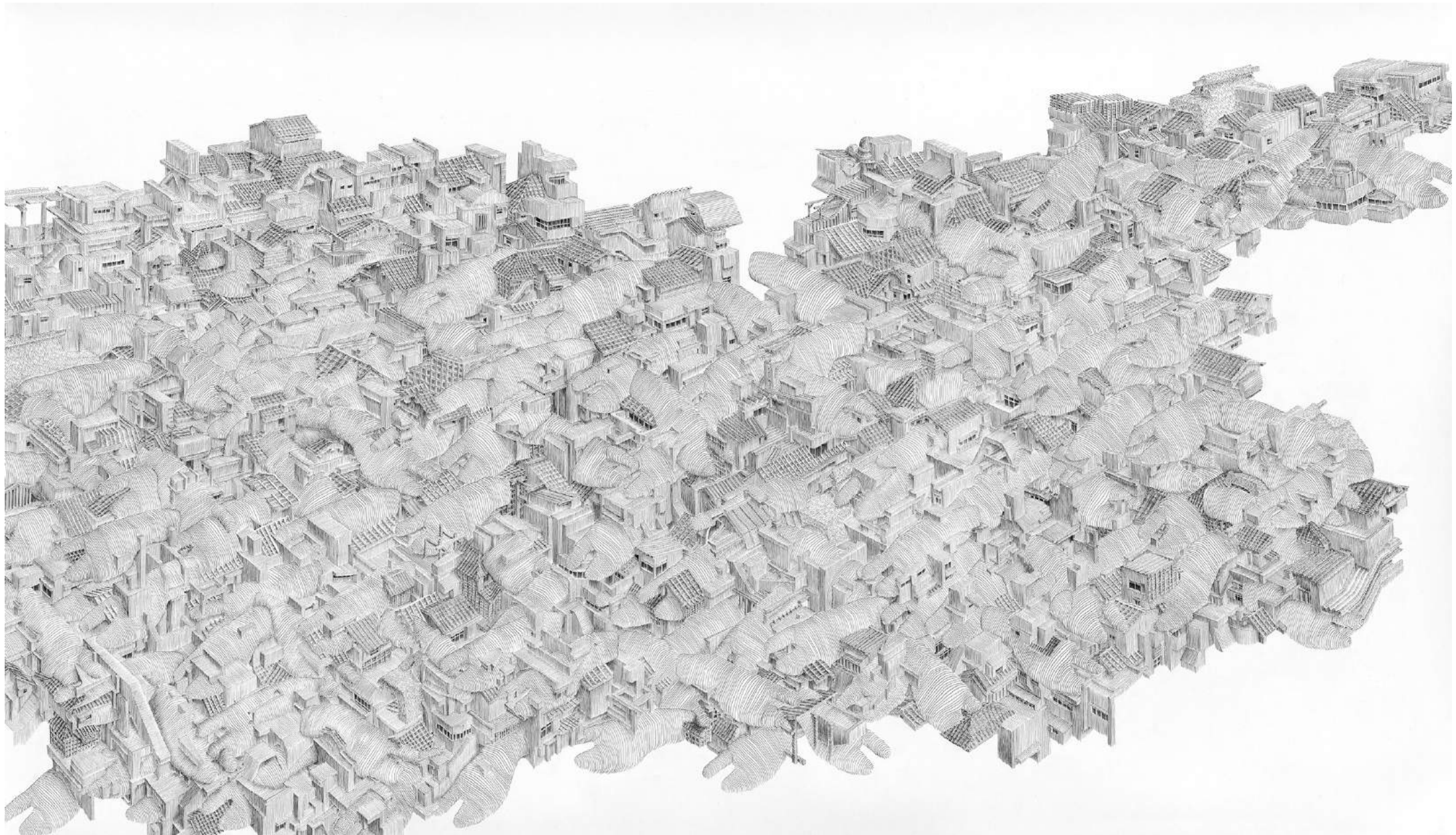

City 18, 2013, Black fineliner on paper, price on request, € 7000,-

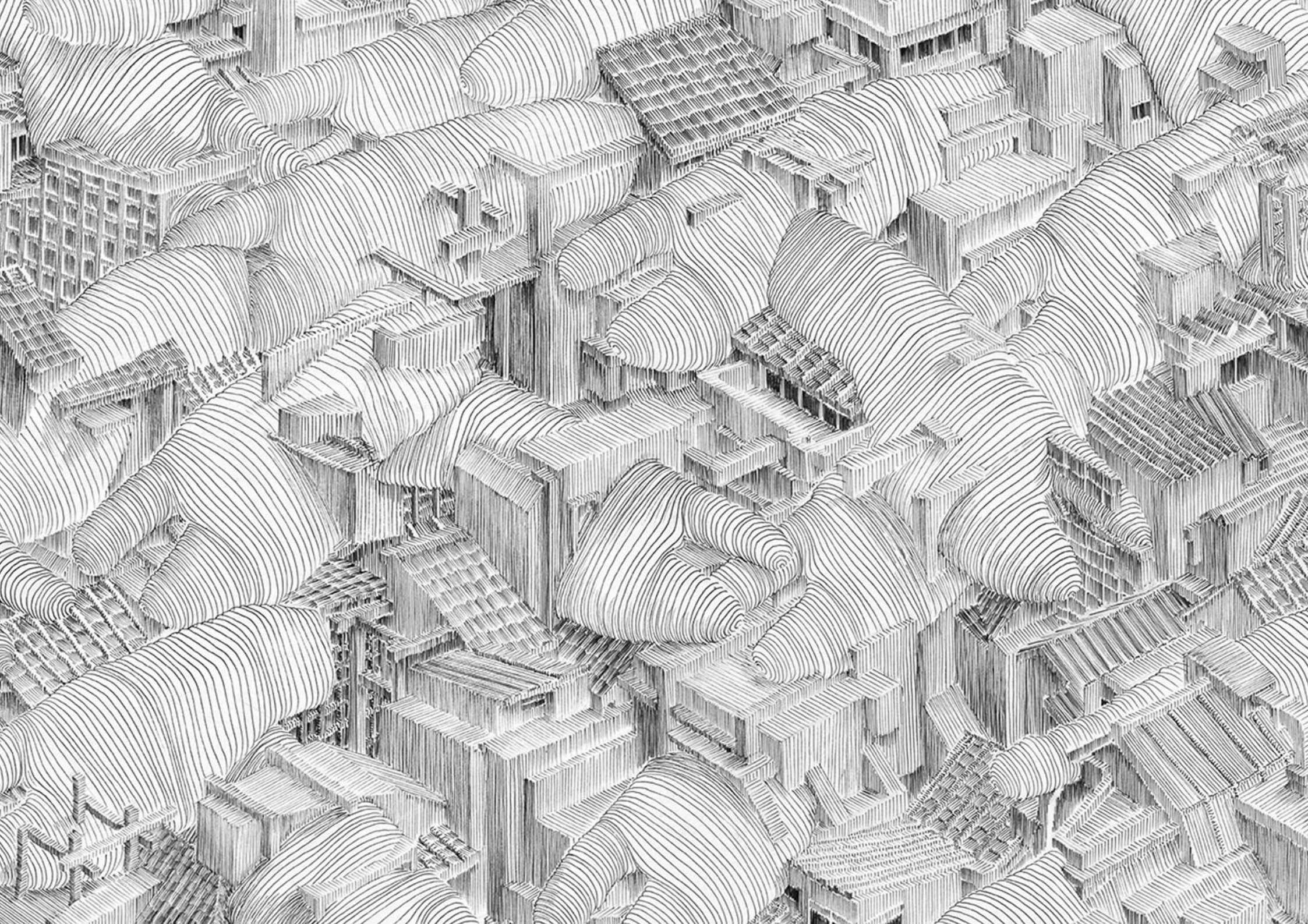

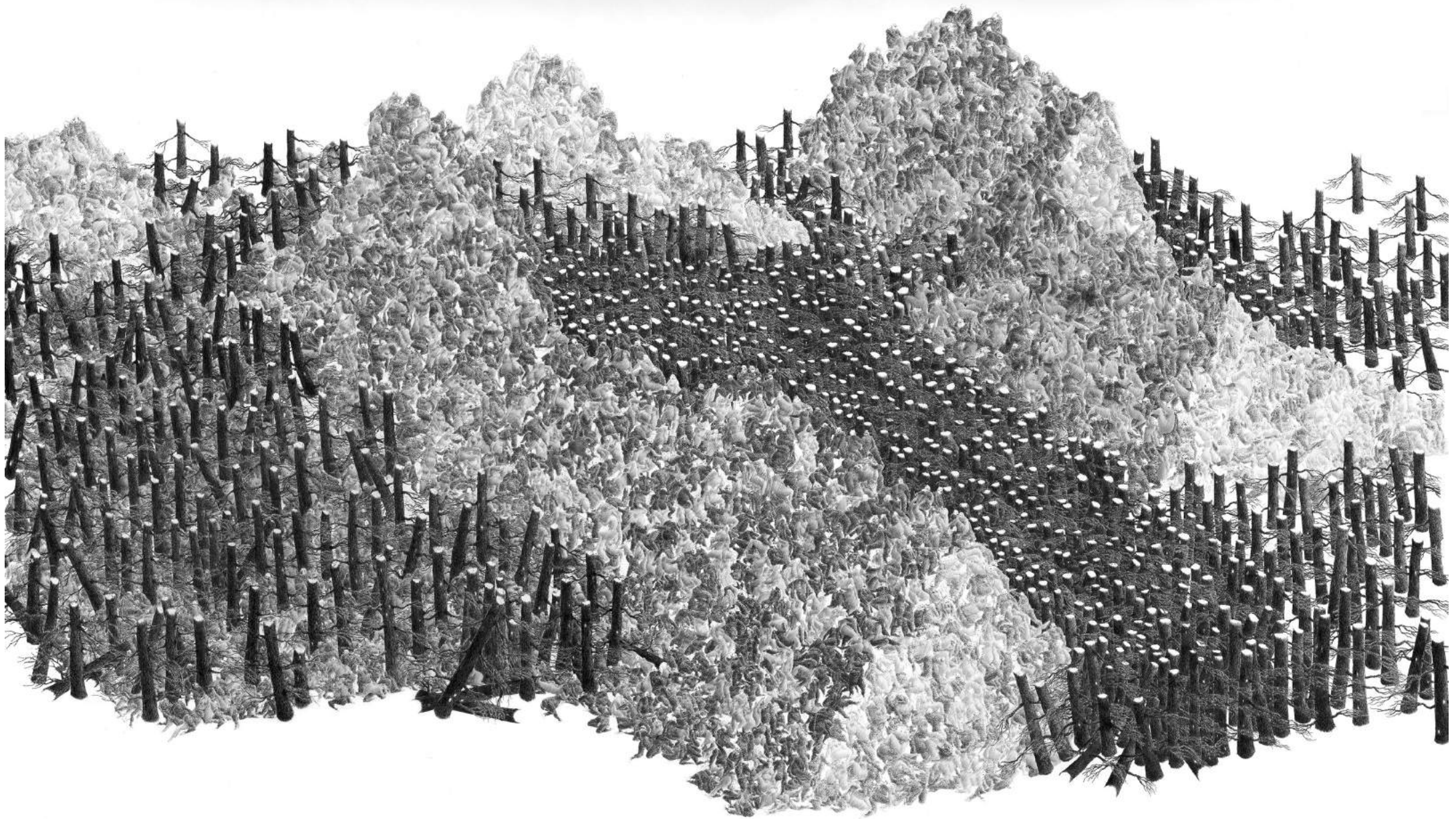

Landscape 21, 2015, Black fineliner on paper, 110 x 197 cm, €9500,-



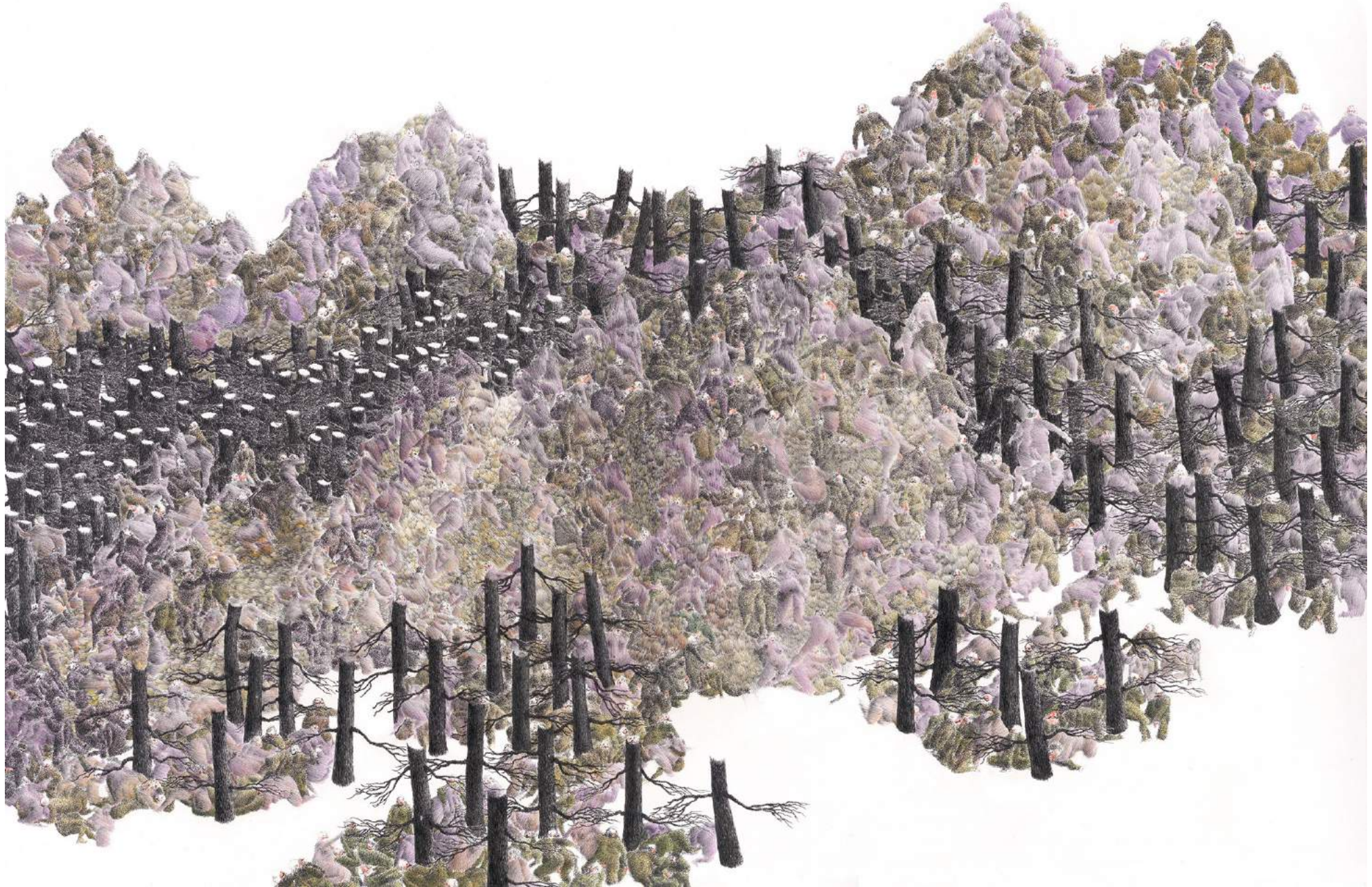

Landscape 22, 2015, Black fineliner, colored pencil on paper, 80 x 109 cm, €6500,-





Landscape 23, 2016, Black fineliner, colored pencil on paper,
142 x 108 cm, € 9500,-



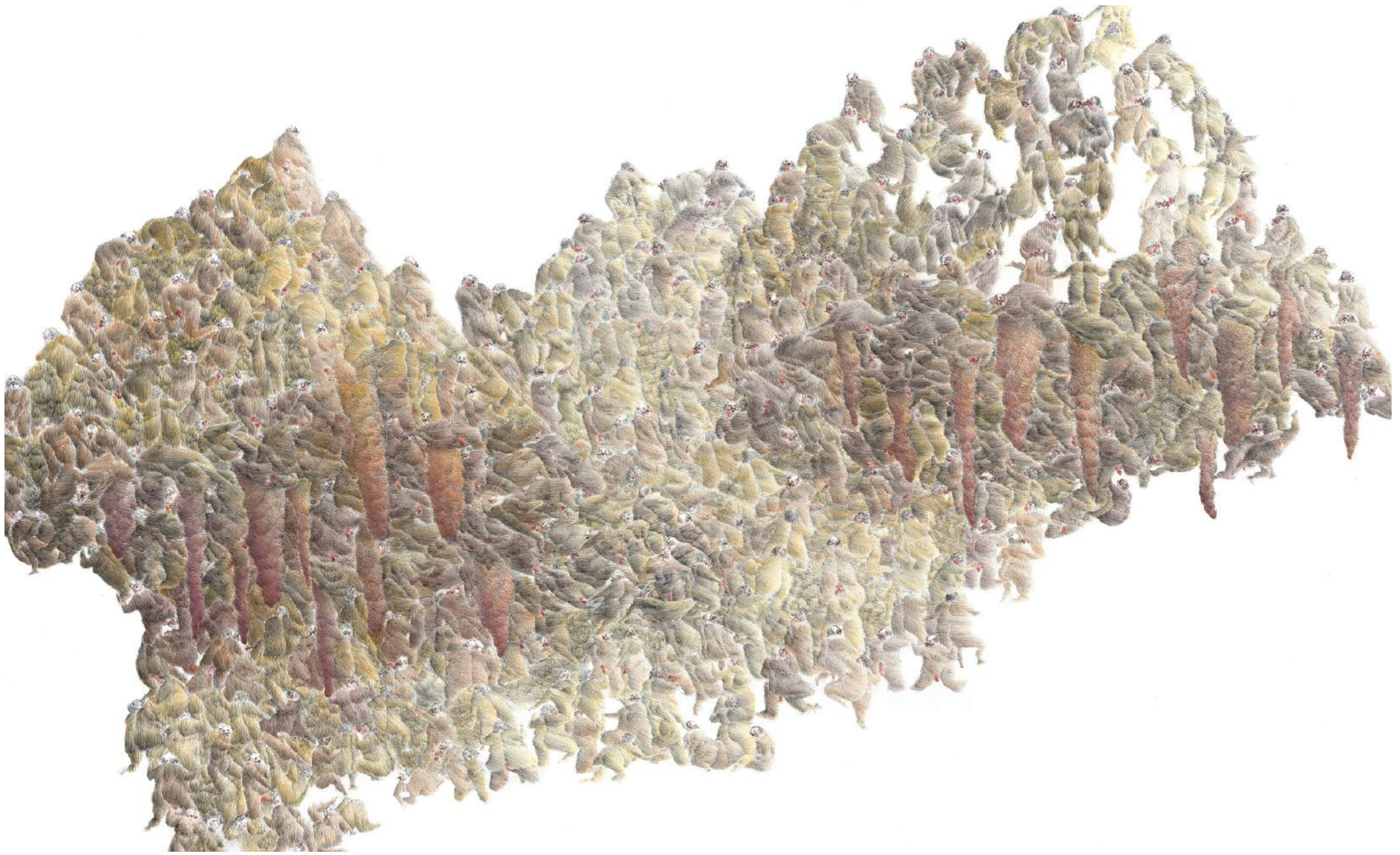

Landscape 24, 2016, Black fineliner, colored pencil on paper, 118 x 78 cm, €4500,-

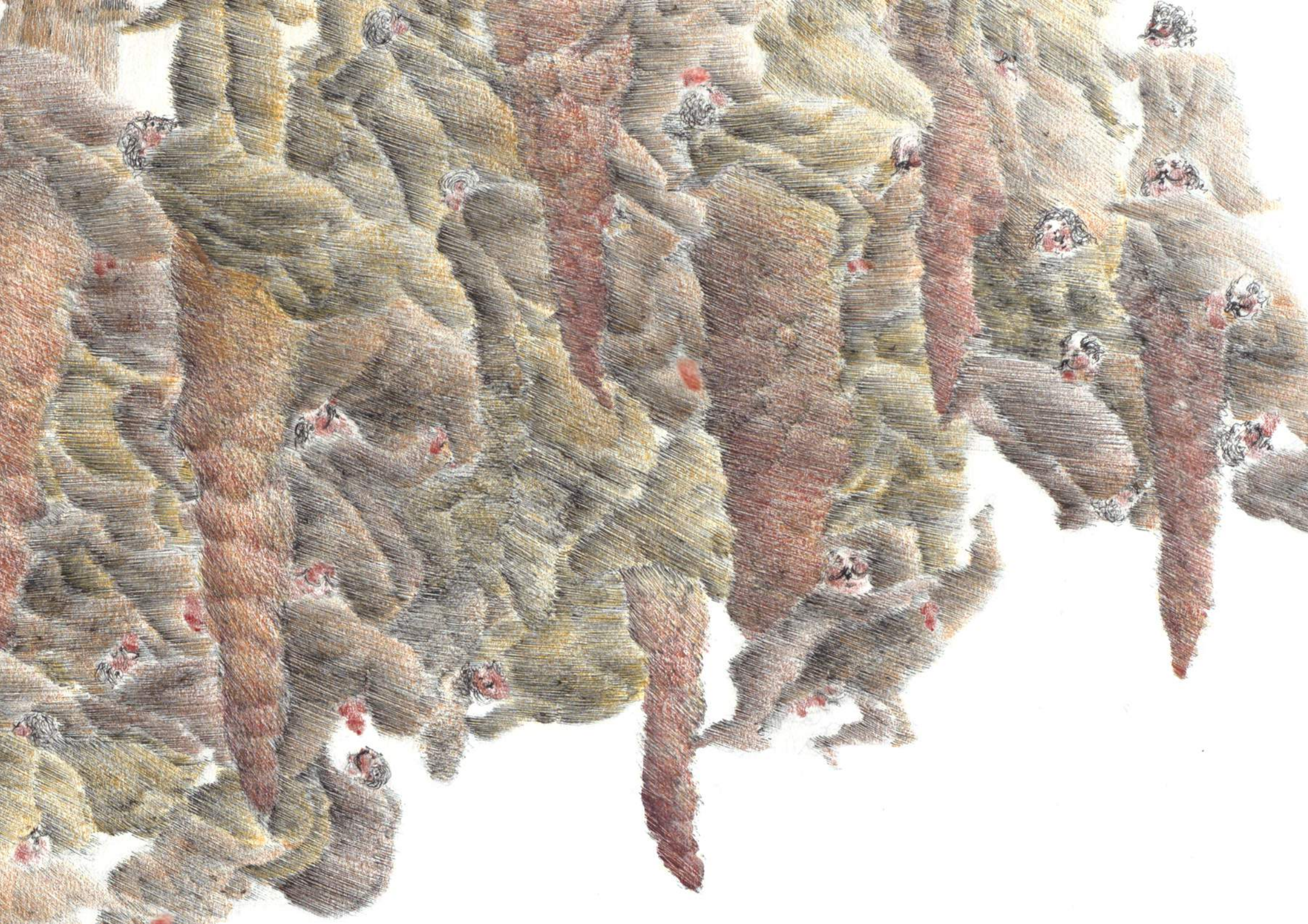



Landscape 25, 2017, 40 x 54 cm, Black fineliner and colored pencil on paper, €2000,-



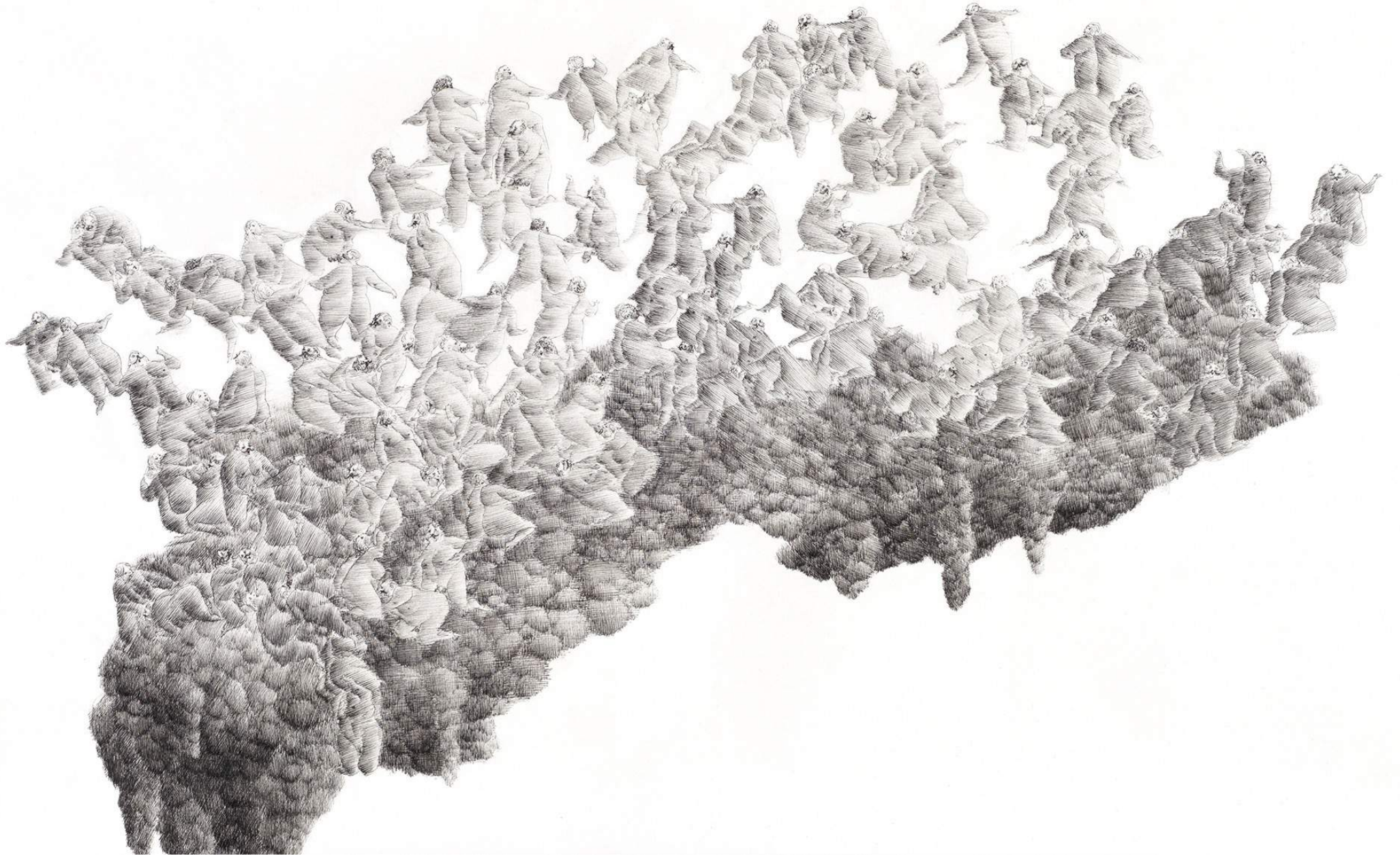

Landscape 26, 2017, 68 x 43 cm, Black fineliner and pencil on paper, €1750,-

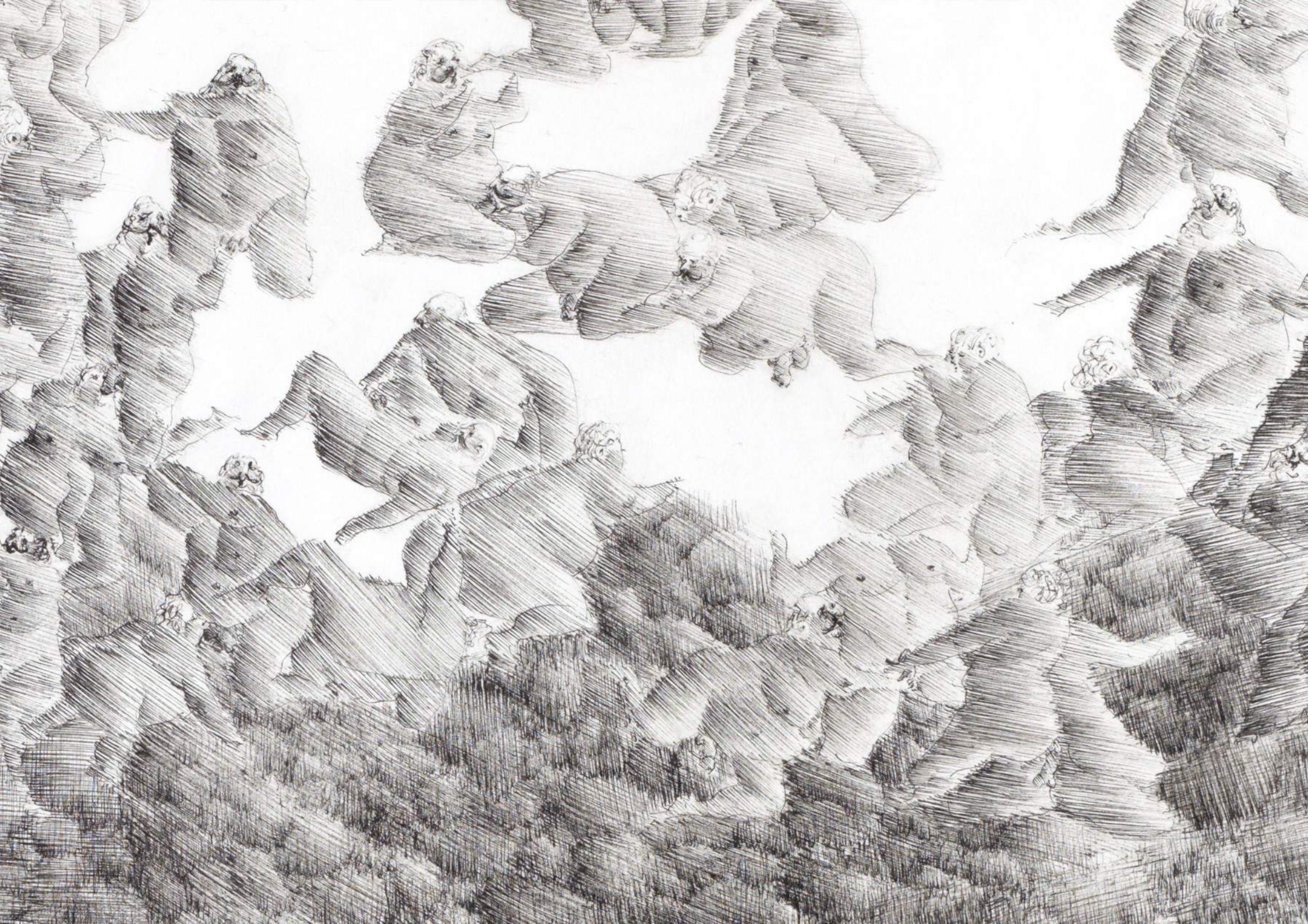

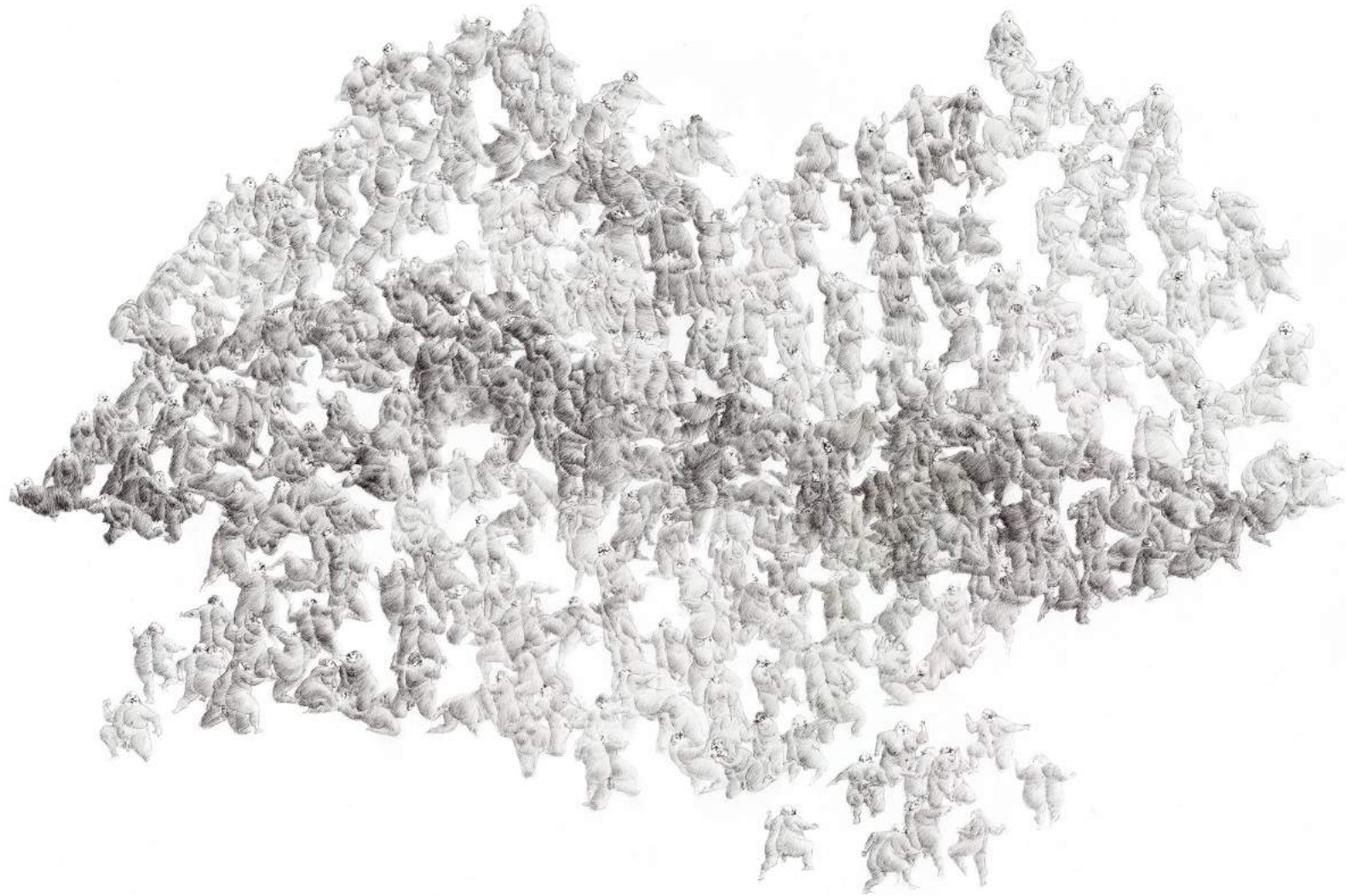

Landscape 27, 2017, 104 x 74 cm cm, Black fineliner and pencil on paper, €3500,-



CV Georg Bohle

1977, Duitsland

Education and Work

Design Academy Eindhoven
Bachelor of Design, Eindhoven;
2000—2007

Elisava Design School
Study Abroad, Barcelona; 2004

Studio Makkink & Bey
Public Space, Furniture and
Interior Design, Rotterdam; 2007
—2010

Awards

Mondriaan Fonds
Working Grant; 2014

The Universe and Other Systems
Artist in Residence; 2014

Mondriaan Fonds
Working Grant; 2012

Fonds BKVB, Tokyo Wonder Site
Artist in Residence; 2011

Collections

Carla and Hugo Brown
Private Collection, The Hague

UHI Bohemia
Corporate Collection, Prague

Various Private Collections

Teaching

Technical University Delft
Drawing Instructor, Faculty of
Architecture, Delft; 2014—Present

Amsterdam School of the Arts
Drawing Instructor, Faculty of
Architecture, Amsterdam; 2014—
Present

Selected Solo Exhibitions

Amsterdam Drawing
Amsterdam; September 2015

Imaginary Landscapes
Galerie Frank Taal
Rotterdam; April 2015

Open Studio
Banff Centre, Banff; August 2014

Re: Rotterdam
Rotterdam; February 2013

Open Studio
Tokyo Wonder Site, Tokyo;
September 2011

de Aanschouw
Rotterdam; August 2011

NAI Nest 18
Dutch Architecture Institute (NAI),
Rotterdam; December 2007

Selected Publications

Scratches 1, Scratch Books, 2016

Expo-Landschapsarchitect
Het financieele Dagblad, 2015

De Grote Rotterdamse
Kunstkalender, 2015

Imagine Architecture
Gestalten Publishers, 2014

Stad in Beeld, Beeld van een Stad
Catalogue; 2013

De Grote Rotterdamse
Kunstkalender
2013

Interview
KetelTV, 2012

Hermetic City
h<art> magazine, Edition 94;
March, 2012

Selected Group Exhibitions

The End, Let's Start Again
Donau83, Berlin, December 2016

What Next (Picture Tomorrow)
Expositieruimte 38CC, Delft,
July—August 2016

Inside Out
Galerie Frank Taal, Rotterdam,
March—April 2016

Rotterdam Contemporary
Rotterdam, February 2016

DiverCity
CIAP Association For
Contemporary Art, Hasselt;
June—October 2014

Connected 010@020
Galerie Roger Katwijk,
Amsterdam, June—July 2014

Georg Bohle, Cindy Jansen en
Bas Zoontjens
Rechtbank Rotterdam, Rotterdam;
February 2014

The Great Last Minute Art Fair
Galerie Frank Taal, Rotterdam;
February 2014

Untitled
Rechtbank Rotterdam, Rotterdam;
February 2014

Hello@Spinnerei Leipzig
Spinnerei Leipzig, Leipzig;
September 2013

Stad in Beeld, Beeld van een Stad
Stedelijk Museum Zwolle, Zwolle;
June 2013

Zoetermeer Utopia
Stadsmuseum Zoetermeer,
Zoetermeer; May 2013

Imaginary Cities and Dutch
Cowboys
Galerie Frank Taal, Rotterdam;
April 2013

Figure This
Galerie Frank Taal, Rotterdam;
July—September 2012

Slick Art Brussels
Brussels; April 2012

Hermetic City
Garage, Rotterdam; March 2012

Paviljoen Rotterdam
Rotterdam; February 2012

C'era una Volta
Galerie Frank Taal, Rotterdam;
May 2011

Project area Dek22
Rotterdam; September 2010

Version Fest / Dark Matter
Eastern Expansion, Chicago; April
2009

Lectures

Monnikenwerk
Het Nieuwe Instituut, Rotterdam;
2014

Radio Calling
TENT at the Witte de With,
Rotterdam; 2014

The Universe and Other Systems
The Banff Centre, Banff; 2014

Galerie **Frank Taal** is een eigentijdse galerie. Met acht tot tien tentoonstellingen per jaar vertegenwoordigt zij het brede bereik dat de verschillende disciplines uit de hedendaagse kunst bieden. Gevestigd in het Oude Westen in Rotterdam, op steenworp afstand van de Nieuwe Binnenweg centrumzijde, toont Galerie Frank Taal werk van opkomende en internationaal gevestigde kunstenaars. In elke presentatie ligt de nadruk op de totaalbenadering van de tentoonstelling. Gezocht wordt naar de perfecte harmonie of de combinatie van spannende tegenstellingen.

Gallery **Frank Taal** is in every sense a contemporary gallery. The gallery's eight to ten exhibitions per year showcase a broad spectrum of contemporary art disciplines. Gallery Frank Taal continues to find fresh talent, as well as supporting and developing the international careers of the gallery's more established artists. Uniquely, Gallery Frank Taal's presentations are made using a holistic approach, offering either perfect harmony or challenging and dynamic juxtapositions. In 2015 Gallery Frank Taal is elected Best Gallery of The Netherlands.



Galerie Frank Taal
Van Speykstraat 129
3014 VH Rotterdam
Nederland

Telefoon
Frank Taal +316 41400927
Leo de Bie +316 30175783

Mail
frank@franktaal.nl
leo@franktaal.nl

Openingstijden
woe-vrij 12:00 - 18:00
za 13:00 - 18:00



**Frank
taal**